

**Enjoy peace of mind.
Register your appliance today.**

Stay updated on better living services, safety notices and shop for accessories.

- 1. Open the camera app on your smartphone and point at the QR code to scan**
Product Registration QR code is located on the front of your appliance or inside the door rim*.

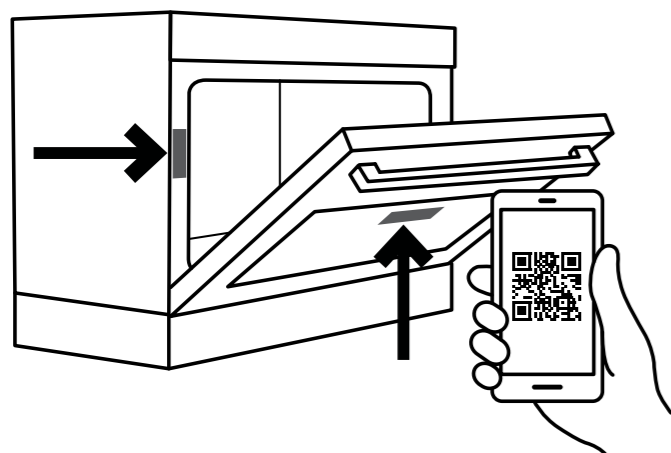

- 2. Tap the notification or link to open the registration form**
- 3. Complete your details and enjoy peace of mind**

*Exact location of QR code may vary depending on oven model



Need more help?

To access your detailed user manual online, simply scan the QR code on your smart phone. If you prefer a printed manual, please contact our Customer Care Centre using details below.



Customer Care Centre

Contact us if you need more help

Electrolux Home Products Australia

telephone: 13 13 49
email: customercare@electrolux.com.au
web: electrolux.com.au

Electrolux Home Products New Zealand

telephone: 0800 436 245
email: customercare@electrolux.co.nz
web: electrolux.co.nz

Dear Customer,

Thank you for purchasing a Westinghouse appliance. You have chosen a product that comes from a history of durable and reliable products loved by many families. We look to help you make the most of your time at home, so you can spend your time doing what you really love, with the ones you love.

Welcome to Westinghouse.

Ready



This is a Quick Start Guide. Please refer to user manual online for detailed information and installation

To access your detailed user manual online, simply scan the QR code on your smart phone.

For more detailed information and installation guide refer to user manuals at westinghouse.com.au/manuals

Before you start, please make sure:

- Your cooker has been correctly installed by a qualified person.
- Your cooker has power and is switched on.
- You've removed all relevant packaging.

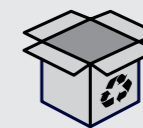

Most of the packaging materials can be recycled. Please dispose of them at your local recycling centre or in your own recycling bin.

Set...

Get to know your control panel:

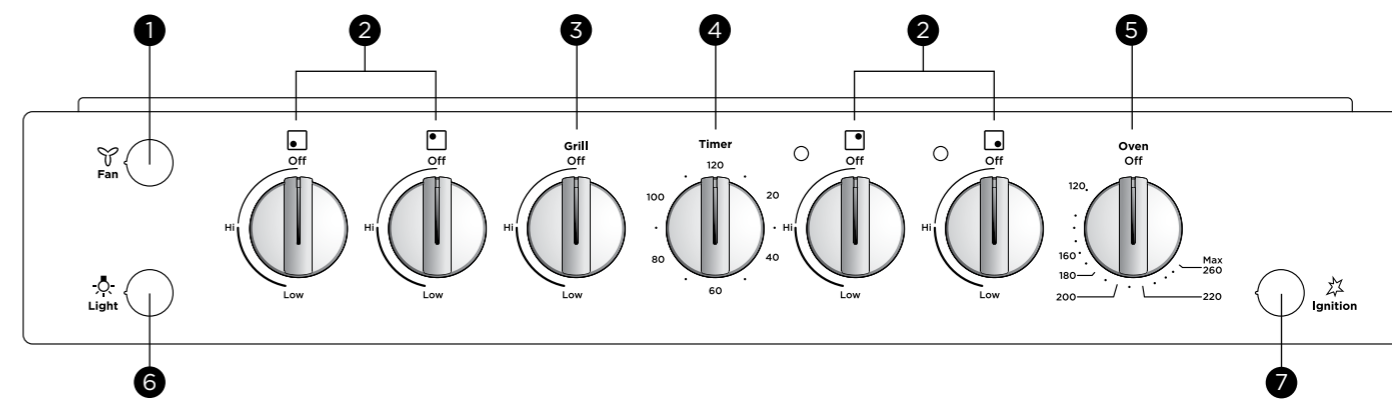

- | | | |
|---|--|----------------------------|
| 1 Oven fan button | 4 120 minute timer | 6 Oven light button |
| 2 Cooktop controls | 5 Oven temperature control knob | 7 Ignition button |
| 3 Grill temperature control knob | | |

Set...

Installing the oven accessories

Fitting the oven shelves

1. Ensure shelf orientation is correct (refer to diagram below).
2. Slide oven shelves onto oven supports (side runners) at an angle until raised back of shelf is past the stop on oven supports (side runners).
3. Lower front of shelf and push in until stop is reached.
4. To remove oven shelves, withdraw to the stop and raise the front of shelf to clear the stop.

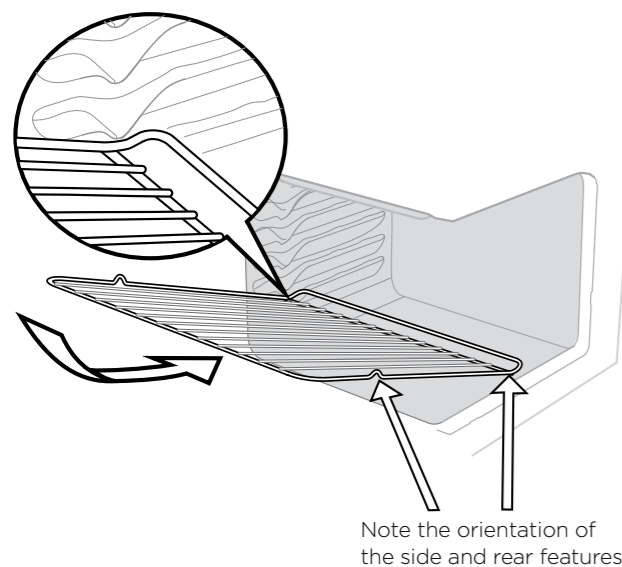

Oven shelf location

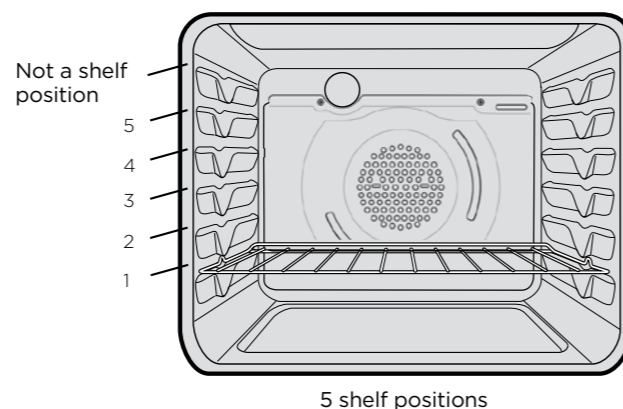

NOTE: The top ledge is not a shelf position. There are no stops for shelf withdrawal.

Separate grill

To insert the grill tray in a separate grill underbench product, open the grill door and fully extend the grill drawer. Position the grill tray so that the slots on the outer edges fit over the tabs on the slides.

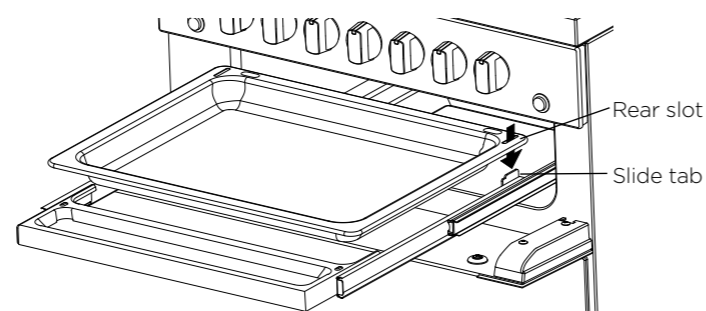

Condition the oven

(to burn off any residue)

New appliances can have oil or residue left from manufacturing. You will need to heat your oven for 30 minutes before using it for the first time.

1. Using the oven control knob, set the oven at 180°C for approximately 30 minutes.
2. Later, run the grill on maximum for 15 minutes with the grill door open.

Please ensure that the room is well ventilated during this process.

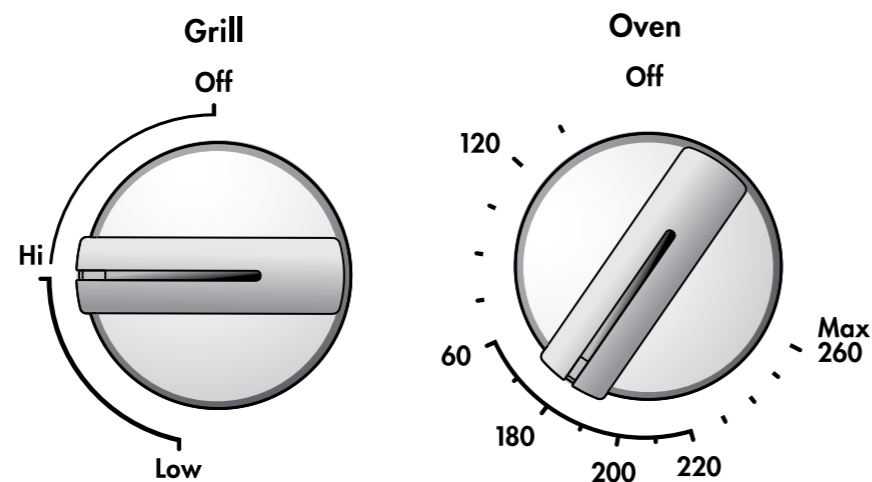

Go!

You're ready to use your new Westinghouse appliance. A few tips from us:

Lighting the gas hotplate, grill and oven

Cooktop ignition

To light a cooktop burner, turn the appropriate burner control knob to maximum and at the same time press the ignition button ★.

Oven ignition

Push and hold Oven Control Knob onto desired temperature and at the same time press the Electronic ignition button ★. Hold control knob in for 5 seconds after ignition.

Grill ignition

Turn the grill temperature control knob onto "HI" and at the same time press the ignition button ★. This burner also has flame failure, so it is required to depress the knob approximately 5 seconds after the flame is established. If the flame goes out when the knob is released, simply depress the knob again, this time holding it down with slightly more force for the same length of time.

⚠ WARNING

- Keep hands clear of burners when lighting.
- If burner does not light within 5 seconds, turn the knob to 'Off' position, allow gas to disperse, then try lighting again.
- Burners MUST be operated between 'High' and 'Low' settings only.

☐ Remember to pre-heat each time.

For best cooking results pre-heat the oven. Pre-heating allows the oven to reach the required temperature quickly and efficiently as well as cook food at the correct temperature for the entire cook time. Recommended pre-heat time is 30 minutes for baking and 3 minutes for grilling.

OVEN

The fan forced electric oven is perfect for multi-level cooking or reheating entire meals for your family. The hot air in the oven is distributed by a fan behind the rear wall of the oven, providing an even temperature on all shelf levels - making more consistent, delicious results easy to achieve.

Refer to your full user manual for more details on oven functions.

☐ Set your temperature

- To set the temperature, turn the grill/oven temperature selector knob to the desired setting.
- An indicator light in the display will turn on and the grill/oven will begin to heat.
- Once the food is cooked, turn the temperature selector back to the off position.

☐ Set a Timer (where fitted)

- To set the timer, simply turn the knob clockwise to the required number of minutes.

NOTE: For any time below 10 minutes, turn the knob past the 30 minute mark, then turn it back to the required number of minutes.