

KIT CONTENTS

	DESCRIPTION	QTY
	Top hinge cap RH	2
	Top hinge cover LH	2
	Top hinge LH	1
	Centre hinge LH	1
	Bottom hinge LH	1
	Base support RH	1
	Door stopper LH	2

NOTE: Keep kit parts separate from other parts as you disassemble them to avoid mix-ups.

TOOLS YOU WILL NEED (not supplied)

	Phillips head screwdriver
	8mm (5/16") hex head socket

WARNING

Westinghouse takes no responsibility for incorrectly assembled doors leading to injury or malfunction.

CAUTION

Refrigerator must stand for 30 minutes prior to connecting to power supply to ensure system functions correctly.

IMPORTANT

All hinge screws require tightening to a torque setting of 5-10Nm

FRIDGE DESCRIPTION

Top view of right hand hinge cabinet

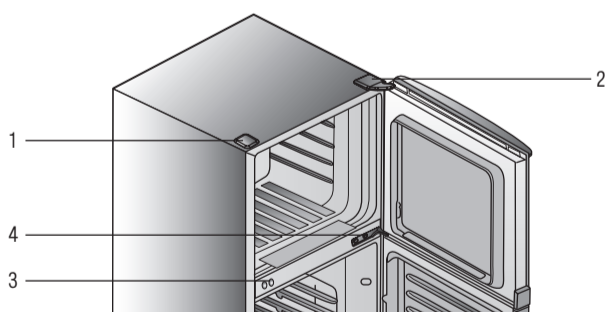

Bottom view of right hand hinge cabinet

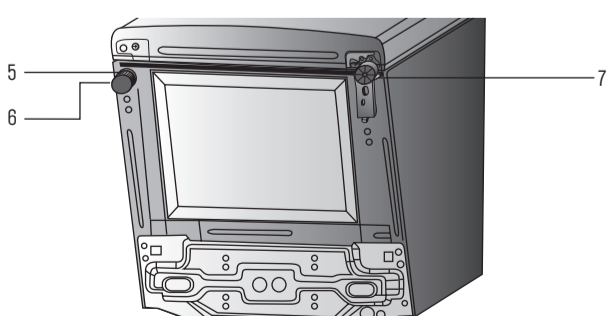

- 1 LH top hinge cap
- 2 RH top hinge and hinge cover
- 3 Centre hinge cap and screws
- 4 RH centre hinge and screws
- 5 Adjustable foot
- 6 Base support
- 7 RH bottom hinge assembly

INSTRUCTIONS

1. Ensure refrigerator is empty of all loose items and unplugged from power source.

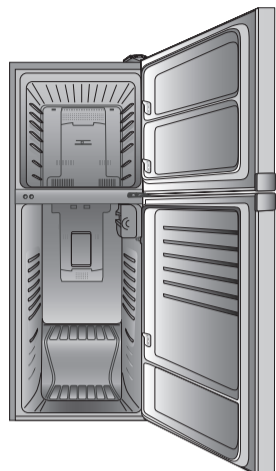

2. Store power cord next to motor to prevent damage. Check for water in drain pan and remove any water with a cloth or sponge if necessary.

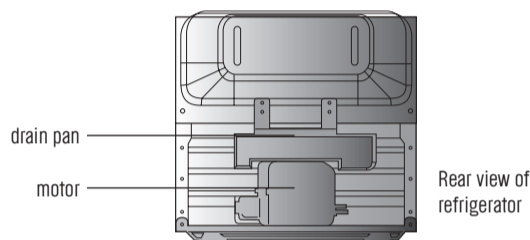

3. Lay the refrigerator on its back.

WARNING

Your refrigerator is heavy – you may need assistance.

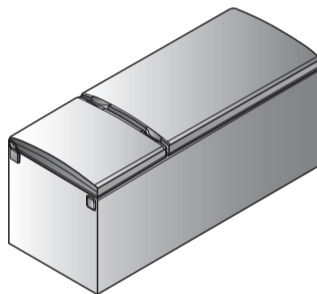

4. Remove the hinge cover with a soft plastic lever.

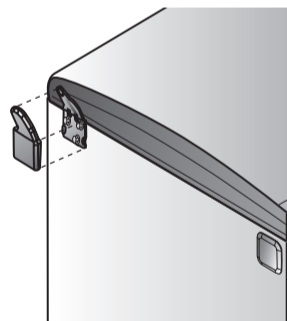

5. Remove the LH cap with a soft plastic lever.

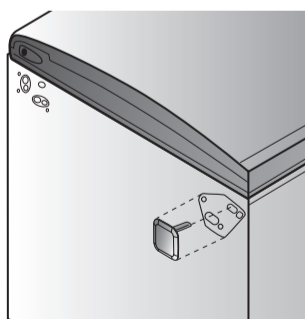

6. Unscrew 3 x 8mm top hinge screws and remove RH top hinge. Do not discard screws.

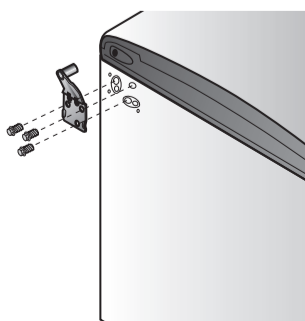

7. Remove freezer door by opening 45° and gently slide off hinge. Set door aside to prevent damage.

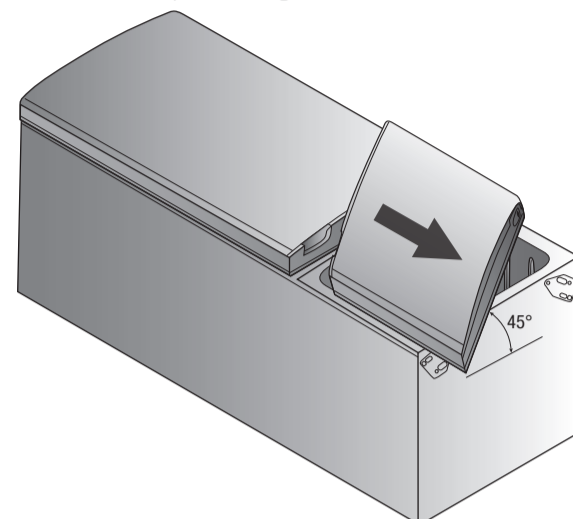

8. Unscrew 2 x 8mm centre hinge screws. Do not discard screws.

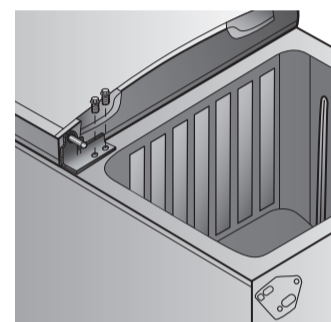

9. Remove RH centre hinge by lifting the door slightly and sliding hinge out of the door.

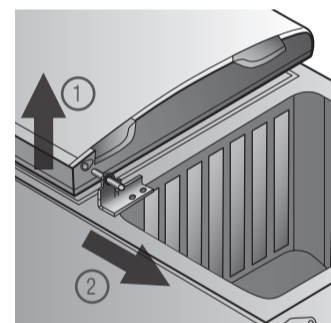

10. Remove food door by opening 45° and gently slide off hinge. Set door aside to prevent damage.

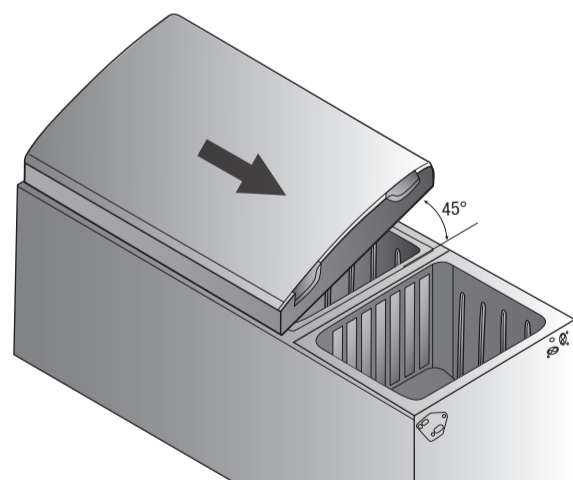

11. Remove both the nylon bearing and the nylon bearing cap from the top of door and swap positions. Repeat with freezer door. Remove RH door stopper and replace LH door stopper.

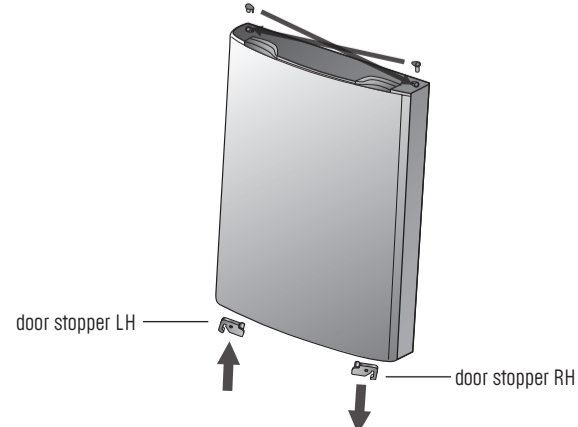

12. Remove the centre hinge caps with plastic lever and unscrew 2 x 8mm screws replace both screws and caps in the centre hinge holes on the opposite side.

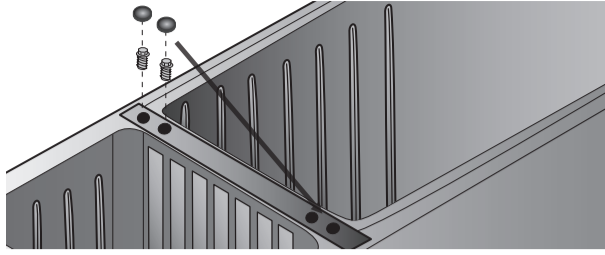

13. Unscrew the hinge foot using phillips head screwdriver and unscrew foot on opposite side. Do not discard.

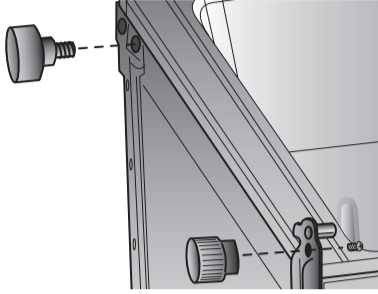

14. Unscrew the bottom hinge screw shown, pull the hinge away from cabinet then up to remove.

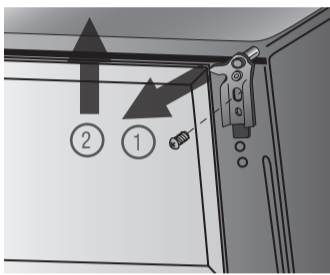

15. Place the base support RH (kit contents) onto the cabinet, placing it down then towards cabinet to install. Replace the screw.

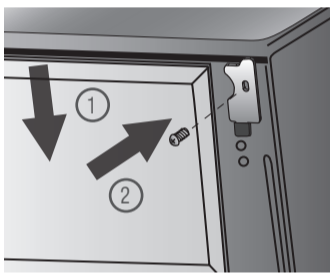

16. Unscrew the base support LH screw shown, pull the support away from cabinet then up to remove.

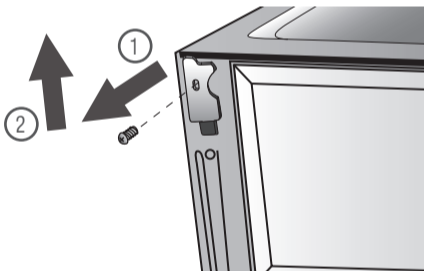

17. Place the bottom hinge LH (kit contents) onto the cabinet, placing it down then towards cabinet to install. Replace the screw.

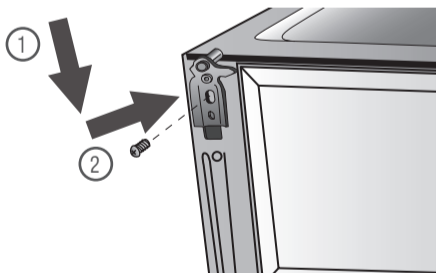

18. Replace the hinge foot onto the LH bottom hinge and tighten with screw. Screw the other foot into the corresponding hole.

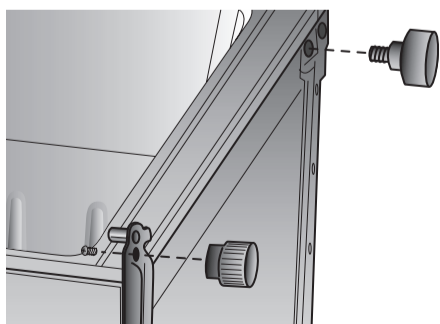

19. Replace the food door by holding at 45° and gently slide onto the bottom hinge and closing the door.

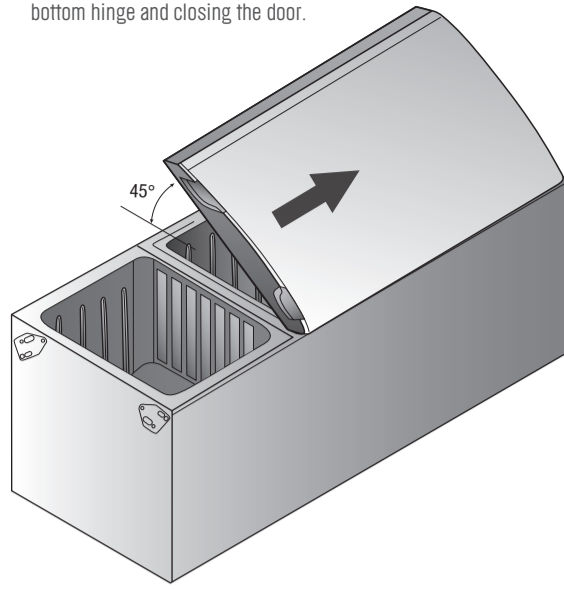

20. Replace LH centre hinge by lifting the door slightly and sliding hinge into the door and placing the door down again.

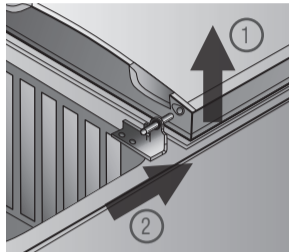

21. Insert 2 x 8mm screws from existing centre hinge into the LH centre hinge, tighten the screws until the bracket is secured.

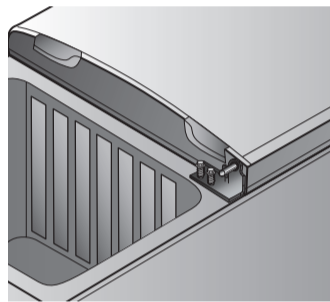

22. Replace the freezer door by holding at 45° and gently slide onto the centre hinge and closing the door.

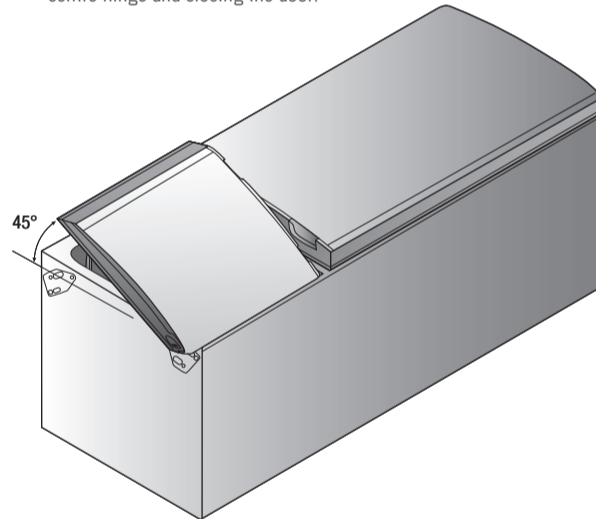

23. Slide the LH top hinge (kit contents) into the door, loosely screw the 3 x 8mm screws from the existing top hinge in the cabinet.

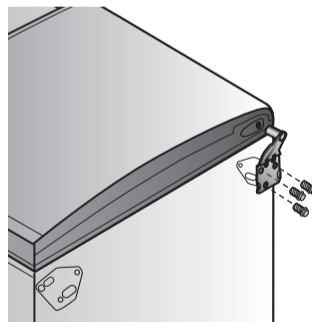

24. Ensure that the edges of the doors are parallel with the sides of the cabinet.

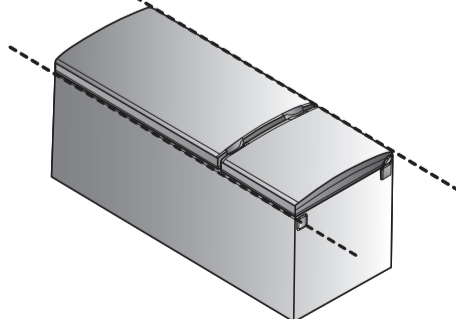

25. Ensure that the food door and the freezer door have a parallel gap.

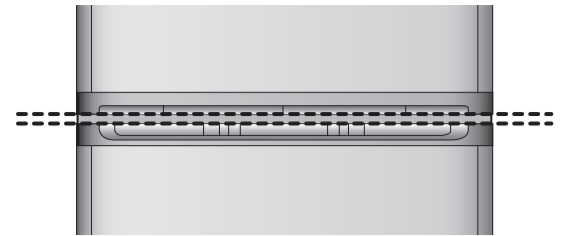

26. Fully tighten the LH top hinge to the cabinet until the hinge is secure.

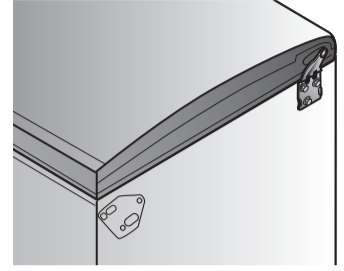

27. Clip the LH hinge cover (kit contents) over LH top hinge.

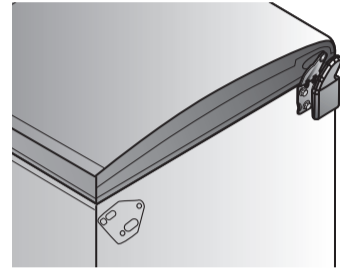

28. Insert the RH top hinge hole cap (kit contents) in the cabinet as shown.

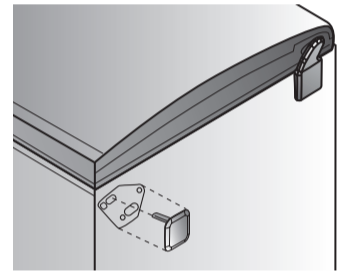

29. Stand the refrigerator upright.



WARNING

Your refrigerator is heavy – you may need assistance.

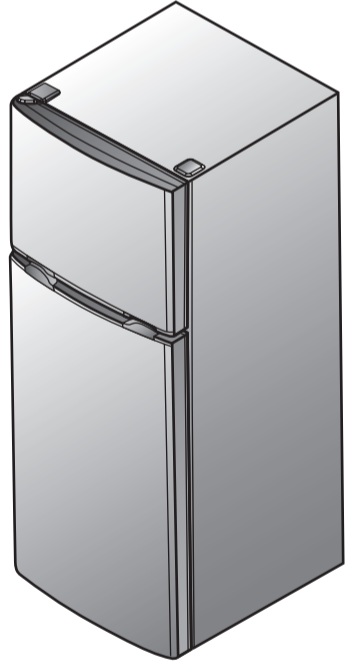

30. Level the cabinet by adjusting the foot. NOTE: the adjustable foot is on the opposite side to the hinge.



For further information on all Westinghouse appliances, or to obtain detailed dimension and installation information, call into your Retailer, phone or email our Customer Care team or visit our website:

AUSTRALIA
phone: 1300 363 640
fax: 1800 350 067
email: customercare@electrolux.com.au
web: www.westinghouse.com.au
www.simpson.com.au

NEW ZEALAND
phone: 09 573 2384
fax: 0800 363 600
email: customercare@electrolux.co.nz
web: www.westinghouse.co.nz
www.simpson.co.nz

Westinghouse and Simpson. We are part of the Electrolux family.
Share more of our thinking at www.electrolux.com

© 2007 Electrolux Home Products Pty Ltd ABN 51 004 762 341
Print code: WMANDORREV_Jul 07
Part number: 2432829 00